

**FIRE LANE STRIPING DETAIL**

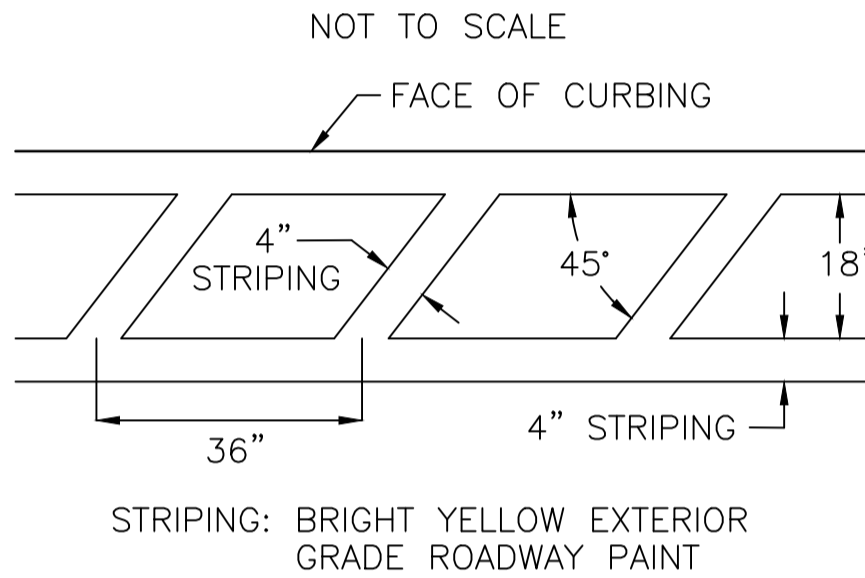

LETTERING AND BORDER - RED BACKGROUND - WHITE  
**FIRE ZONE SIGN**

**DISTRICTS**  
SCHOOL: PEARL RIVER UNION FREE SCHOOL DISTRICT  
FIRE: PEARL RIVER  
WATER: TOWN OF ORANGETOWN  
LIBRARY: PEARL RIVER  
AMBULANCE: SOUTH ORANGETOWN

**LEGEND**

DR	DRAIN
SMH	SANITARY MANHOLE / PIPE
G	GRANITE CURB
G	GAS LINE / VALVE
W	WATER LINE / VALVE
UP	UTILITY POLE
OHW	OVERHEAD WIRES
P	PROPERTY LINE
P	PARKING METERS
CE	CELLAR ENTRY ACCESS
▶	BUILDING ENTRANCE

	BULK REGULATIONS				ZONE: CS				USE: RESTAURANT			
	MAX F.A.R.	MIN LOT AREA	LOT WIDTH	FRONT YARD	SIDE YARD	TOTAL SIDE YARD	REAR YARD	MAX BLDG HEIGHT	FRONTAGE	MAX BLDG HEIGHT	FRONTAGE	MAX BLDG HEIGHT
REQUIRED	1.00	2500 SF	25'	0 OR 45'	0 OR 12'	0 OR 25'	25'	14" FROM PL FOR BLDG >22'	25'			
EXISTING LOT 13	0.95	7560 SF	54.0'	0'	0' / 0'	0.7' ⊕	56.8' TO BLDG	2 STY	54.0'			
WALK IN CHILLER BAR (EAST)	TOTAL F.A.R = 1.04 ⊕	N/A	N/A	N/A	1.9' ⊕	NO CHANGE	6.6' ⊕	16'	N/A			
FRAME COVERING		N/A	N/A	N/A	0'	NO CHANGE	42'	10.1'	N/A			
		N/A	N/A	N/A	0'	NO CHANGE	8.5' ⊕	16.2'	N/A			

⊕=VARIANCE REQUIRED  
⊕=STRUCTURE CROSSES PROP. LINE

VARIANCES REQUIRED FOR DISTANCE BETWEEN COVERED BAR & MAIN BLDG (REQ=15';PROV=11.3') ⊕

- NOTES:**
- THIS IS A SITE PLAN OF TAX LOT 68.20-1-13, AS SHOWN ON THE TOWN OF ORANGETOWN TAX MAPS.
  - RECORD OWNER: DEBRABRAD REALTY LLC, 4 INDEPENDENCE AVE, TAPPAN, NY 10983
  - APPLICANT: SAME
  - LOT AREA: 7560 SF
  - ALL NEW UTILITIES, INCLUDING ELECTRIC AND TELEPHONE SERVICE SHALL BE INSTALLED UNDERGROUND.
  - THIS PLAN DOES NOT CONFLICT WITH THE COUNTY OFFICIAL MAP, AND HAS BEEN APPROVED IN THE MANNER SPECIFIED BY SECTION 239-L & M OF THE GENERAL MUNICIPAL LAW OF THE STATE OF NEW YORK.
  - THIS PLAN IS SUBJECT TO DETAILS OF GRADING, ROADS AND UTILITIES AS SHOWN ON CONSTRUCTION PLANS APPROVED BY THE PLANNING BOARD AND FILED WITH THE TOWN CLERK.
  - LOT DRAINAGE SHOWN ON SUCH PLANS SHALL CONSTITUTE EASEMENTS RUNNING WITH THE LAND AND SHALL NOT BE DISTURBED.
  - ANY EXISTING UTILITIES (POLES, HYDRANTS, ETC.) AFFECTED BY CONSTRUCTION OF THIS SITE PLAN SHALL BE RELOCATED AT THE DEVELOPER'S EXPENSE PRIOR TO THE ISSUANCE OF ANY CERTIFICATE OF OCCUPANCY.
  - MONUMENTS TO BE SET AT ALL CORNERS OF THE ORIGINAL PARCEL WHERE NOT OTHERWISE MARKED (SHOW THUS: )
  - CERTIFICATE OF OCCUPANCY SHALL NOT BE REQUESTED FROM THE TOWN OF ORANGETOWN BUILDING DEPARTMENT UNTIL RESULTS OF INFILTRATION AND EXFILTRATION TESTS FOR SANITARY SEWERS ARE CERTIFIED BY A NEW YORK STATE LICENSED PROFESSIONAL ENGINEER AND APPROVED BY THE TOWN.
  - ALL AREAS DISTURBED BY ON-SITE GRADING WILL BE LIMED AND FERTILIZED PRIOR TO SEEDING.
  - SIDEWALKS AND CURBS, WHERE REQUIRED, SHALL BE INSTALLED IN ACCORDANCE WITH THE HIGHWAY DEPT.
  - NO BUILDING PERMIT SHALL BE ISSUED UNTIL RESULTS OF TEST PITS HAVE BEEN SUBMITTED TO THE BUILDING DEPT.
  - NO BUILDING PERMIT SHALL BE ISSUED UNTIL SITE PLANS HAVE BEEN APPROVED BY ACABOR.
  - WATER SUPPLY: VEOLIA NY
  - DATUM: NAVD 88
  - ALL SEWER CONNECTIONS SHALL BE APPROVED BY THE TOWN OF ORANGETOWN DEPARTMENT OF ENVIRONMENTAL MANAGEMENT AND ENGINEERING.
  - AT LEAST ONE WEEK PRIOR TO THE COMMENCEMENT OF ANY WORK, INCLUDING THE INSTALLATION OF EROSION CONTROL DEVICES OR THE REMOVAL OF TREES AND VEGETATION, A PRE-CONSTRUCTION MEETING MUST BE HELD WITH THE TOWN OF ORANGETOWN DEPT. OF HIGHWAYS AND THE OFFICE OF BUILDING, ZONING & PLANNING ADMINISTRATION AND ENFORCEMENT. IT IS THE RESPONSIBILITY AND OBLIGATION OF THE PROPERTY OWNER TO ARRANGE SUCH A MEETING.
  - ALL LANDSCAPING SHOWN ON THE SITE PLAN SHALL BE MAINTAINED IN A VIGOROUS GROWING CONDITION THROUGHOUT THE DURATION OF THE USE OF THIS SITE. ANY PLANTS NOT SO MAINTAINED SHALL BE REPLACED WITH NEW PLANTS AT THE BEGINNING OF THE NEXT IMMEDIATELY FOLLOWING GROWING SEASON.
  - PRIOR TO THE COMMENCEMENT OF ANY SITE WORK, INCLUDING THE REMOVAL OF TREES, THE APPLICANT SHALL INSTALL THE SOIL EROSION & SEDIMENTATION CONTROL AS REQUIRED BY THE PLANNING BOARD. PRIOR TO THE AUTHORIZATION TO PROCEED WITH ANY PHASE OF THE SITE WORK, THE TOWN DEPT SHALL INSPECT THE INSTALLATION OF ALL REQUIRED SOIL EROSION & SEDIMENTATION CONTROL MEASURES. THE APPLICANT SHALL CONTACT DEMA AT LEAST 48 HOURS IN ADVANCE FOR AN INSPECTION.
  - THE CONTRACTOR'S TRAILER, IF ANY IS PROPOSED, SHALL BE LOCATED AS APPROVED BY THE PLANNING BOARD.
  - IF THE APPLICANT, DURING THE COURSE OF CONSTRUCTION, ENCOUNTERS SUCH CONDITIONS AS FLOOD AREAS, UNDERGROUND WATER, SOFT OR SILTY AREAS, IMPROPER DRAINAGE OR ANY OTHER UNUSUAL CIRCUMSTANCES OR CONDITIONS THAT WERE NOT FORESEEN IN THE ORIGINAL PLANNING, SUCH CONDITIONS SHALL BE REPORTED IMMEDIATELY TO DEMA. THE APPLICANT SHALL SUBMIT THEIR RECOMMENDATIONS AS TO THE SPECIAL TREATMENT TO BE GIVEN SUCH AREAS TO SECURE ADEQUATE PERMANENT AND SATISFACTORY CONSTRUCTION. DEMA SHALL INVESTIGATE THE CONDITION(S), AND SHALL EITHER APPROVE THE APPLICANT'S RECOMMENDATIONS TO CORRECT THE CONDITION(S) OR ORDER A MODIFICATION THEREOF. IN THE EVENT OF THE APPLICANT'S DISAGREEMENT WITH THE DECISION OF DEMA, OR IN THE EVENT OF A SIGNIFICANT CHANGE RESULTING TO THE SITE PLAN OR ANY CHANGE THAT INVOLVES A WETLAND REGULATED AREA, THE MATTER SHALL BE DECIDED BY THE AGENCY WITH JURISDICTION IN THAT AREA (i.e. WETLANDS-US ARMY CORPS OF ENGINEERS)
  - PERMANENT VEGETATIVE COVER OF DISTURBED AREAS SHALL BE ESTABLISHED ON THE SITE WITHIN THIRTY (30) DAYS OF THE COMPLETION OF CONSTRUCTION.
  - PRIOR (AT LEAST 14 DAYS) TO THE PLACING OF ANY ROAD SUB-BASE, THE APPLICANT SHALL PROVIDE THE TOWN OF ORANGETOWN SUPT. OF HIGHWAYS & DEMA WITH A PLAN & PROFILE OF THE GRADED ROAD TO BE PAVED IN ORDER THAT THESE DEPARTMENTS MAY REVIEW THE DRAWINGS CONFORMANCE TO APPROVED CONSTRUCTION PLANS & TOWN STREET SPECIFICATIONS.
  - THE PLANNING BOARD SHALL RETAIN JURISDICTION OVER LIGHTING, LANDSCAPING SIGNS, AND REFUSE CONTROL.
  - NO BUILDING PERMIT WILL BE ISSUED UNTIL SEWAGE DISPOSAL ARRANGEMENTS HAVE BEEN APPROVED BY THE ROCKLAND COUNTY DEPT. OF HEALTH, AND/OR THE TOWN OF ORANGETOWN.
  - A TREE PROTECTION PROGRAM WILL BE IMPLEMENTED IN ORDER TO PROTECT AND PRESERVE BOTH INDIVIDUAL SPECIMEN TREES AND BUFFER AREAS WITH MANY TREES. STEPS THAT WILL BE TAKEN TO PRESERVE AND PROTECT EXISTING TREES TO REMAIN ARE AS FOLLOWS:
    - NO CONSTRUCTION EQUIPMENT SHALL BE PARKED UNDER THE TREE CANOPY.
    - THERE WILL BE NO EXCAVATION OR STOCKPILING OF EARTH UNDERNEATH TREES.
    - TREES DESIGNATED TO BE PRESERVED SHALL BE MARKED CONSPICUOUSLY ON ALL SIDES AT A 5 TO 10 FOOT HEIGHT.
    - THE TREE PROTECTION ZONE FOR TREES DESIGNATED TO BE PRESERVED WILL BE ESTABLISHED BY ONE OF THE FOLLOWING METHODS:
      - ONE (1) FOOT RADIUS FROM TRUNK PER INCH DBH
      - D RIP LINE OF THE TREE CANOPY. THE METHOD CHOSEN SHOULD BE BASED ON PROVIDING THE MAXIMUM PROTECTION ZONE POSSIBLE. A BARRIER OF SNOW FENCE OR EQUAL IS TO BE PLACED AND MAINTAINED ONE YARD BEYOND THE ESTABLISHED TREE PROTECTION ZONE. IF IT IS AGREED THAT THE TREE PROTECTION ZONE OF A SELECTED TREE MUST BE VIOLATED, ONE OF THE FOLLOWING METHODS MUST BE EMPLOYED TO MITIGATE THE IMPACT:
        - LIGHT TO HEAVY IMPACTS- MINIMUM OF EIGHT INCHES OF WOOD CHIPS INSTALLED IN THE AREA TO BE PROTECTED. CHIPS SHALL BE REMOVED UPON COMPLETION OF WORK.
        - LIGHT IMPACTS ONLY- INSTALLATION OF 3/4 INCH OF PLYWOOD OR BOARDS, OR EQUAL OVER THE AREA TO BE PROTECTED.
  - THE BUILDER OR ITS AGENT MAY NOT CHANGE GRADE WITHIN THE TREE PROTECTION ZONE OF A PRESERVED TREE UNLESS SUCH GRADE CHANGE HAS RECEIVED FINAL APPROVAL FROM THE PLANNING BOARD. IF THE GRADE LEVEL IS TO BE CHANGED MORE THAN SIX (6) INCHES TREES DESIGNATED TO BE PRESERVED SHALL BE WELLED AND/OR PRESERVED IN A RAISED BED, WITH THE TREE WELL RADIUS OF THREE (3) FEET LARGER THAN THE TREE CANOPY.
  - REFERENCE: ZBA #22-45; 7/06/22. VARIANCES FOR REAR YARD OF 5.3', OUTDOOR DINING & PARKING.

ORANGETOWN PLANNING BOARD APPROVAL

CHAIRMAN \_\_\_\_\_ DATE \_\_\_\_\_

APPROVED FOR FILING BY OWNER \_\_\_\_\_

OWNER \_\_\_\_\_ DATE \_\_\_\_\_

**OWNER:**

TAX LOT 68.20-1-13  
DEBRABRAD REALTY LLC  
4 INDEPENDENCE AVENUE  
TAPPAN, NY 10983

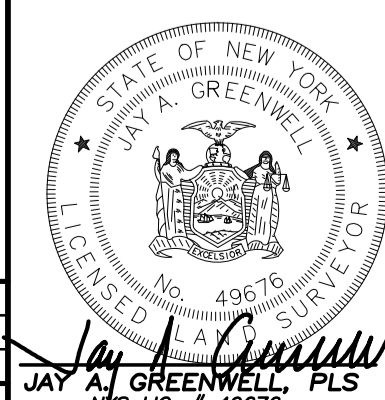

**SITE PLAN OF PROPERTY FOR**  
**14-16 EAST CENTRAL AVE.**

PEARL RIVER, TOWN OF ORANGETOWN  
ROCKLAND COUNTY, NEW YORK

**JAY A. GREENWELL, PLS, LLC**

LAND PLANNING - LAND SURVEYING  
34 WAYNE AVENUE, SUFFERN, NEW YORK 10901  
PHONE 845-357-0830 GREENWELLPLS@AOL.COM  
© 2024 JAY A. GREENWELL, PLS, LLC

TAX LOT #	68.20-1-13
AREA	7560 SF
FILE	22345SITE13
SCALE	1"= 10'
DATE	01/17/24
JOB NO.	22345