

INFILTRATION TESTS				
TEST #	EXPLORED DEPTH (FT)	TEST DEPTH (FT)	AVERAGE RATE (IN/HR)	DEPTH TO ROCKWATER (FT)
IT-28	5	3	19.3	N/A
IT-29	4	2	24.0	N/A
IT-30	7	5	23.8	N/A
IT-31	10	8	13.8	N/A
IT-32	11	9	24.0	N/A
IT-33	12	10	16.8	N/A
IT-34	9	7	19.8	N/A
IT-35	11	9	24.0	N/A
IT-36	9	7	15.0	N/A
IT-37	7	6	1.0	N/A
IT-38	6	4	24.0	N/A
IT-39	6	4	16.0	N/A
IT-40	6	2	22.9	N/A
IT-41	6	4	24.0	N/A
IT-42	4	2	13.4	N/A
IT-43	4	2	24.0	N/A
IT-44	6	4	12.8	N/A
IT-45	6	4	17.8	N/A
IT-46	9.5	8	24.0	N/A

ADA INSTRUCTIONS TO CONTRACTOR:

1. CONTRACTOR SHALL EXERCISE APPROPRIATE CARE AND PRECISION IN CONSTRUCTION OF ADA ACCESSIBLE COMPONENTS FOR THE SITE. THESE COMPONENTS AS CONSTRUCTED, MUST COMPLY WITH THE LATEST ADA STANDARDS FOR ACCESSIBLE DESIGN. FINISHED SURFACES ALONG THE ACCESS ROUTE OF TRAVEL FROM PARKING SPACE, PUBLIC TRANSPORTATION, PEDESTRIAN ACCESS, INTER-BUILDING ACCESS, TO POINTS OF ACCESSIBLE BUILDING ENTRANCE/EGRESS, SHALL COMPLY WITH THESE ADA CODE REQUIREMENTS. THESE INCLUDE BUT ARE NOT LIMITED TO THE FOLLOWING: (NOTE: THIS LIST IS NOT INTENDED TO CAPTURE EVERY APPLICABLE FEDERAL, STATE AND LOCAL RULE AND REGULATION; THE CONTRACTOR IS RESPONSIBLE FOR COMPLIANCE WITH THE LAW, WHETHER OR NOT STATED SPECIFICALLY HEREIN):

A. PARKING SPACES AND PARKING AISLES - SLOPE SHALL NOT EXCEED 1:48 (1/4" PER FOOT OR NOMINALLY 2.0%) IN ANY DIRECTION.

B. CURB RAMPS - SLOPES SHALL NOT EXCEED 1:12 (8.3%).

C. LANDINGS - SLOPES SHALL NOT EXCEED 1:48 (1/4" PER FOOT OR NOMINALLY 2.0%) IN ANY DIRECTION.

D. PATH OF TRAVEL ALONG ACCESSIBLE ROUTE - SHALL PROVIDE A 36 INCH OR GREATER UNOBSTRUCTED WIDTH OF TRAVEL (CAR OVERHANGS CANNOT REDUCE THIS MINIMUM WIDTH). THE SLOPE SHALL BE NO GREATER THAN 1:20 (5.0%) IN THE DIRECTION OF TRAVEL, AND SHALL NOT EXCEED 1:48 (1/4" PER FOOT OR NOMINALLY 2.0%) IN CROSS-SLOPE.

E. WHERE PATH OF TRAVEL WILL BE GREATER THAN 1:20 (5.0%), AN ADA RAMP WITH A MAXIMUM SLOPE OF 1:12 (8.3%), FOR A MAXIMUM DISTANCE OF 30 FEET, SHALL BE PROVIDED. THE RAMP SHALL HAVE ADA HAND RAILS AND "LEVEL" LANDINGS ON EACH END THAT ARE SLOPED NO MORE THAN 1:48 (1/4" PER FOOT OR NOMINALLY 2.0%) FOR POSITIVE DRAINAGE.

F. DOORWAYS - SHALL HAVE A "LEVEL" LANDING AREA ON THE EXTERIOR SIDE OF THE DOOR THAT IS SLOPED NO MORE THAN 1:48 (1/4" PER FOOT OR NOMINALLY 2.0%) FOR POSITIVE DRAINAGE. THIS LANDING AREA SHALL BE NO LESS THAN 60 INCHES (5 FEET) LONG, EXCEPT WHERE OTHER WISE PERMITTED BY ADA STANDARDS FOR ALTERNATIVE DOORWAY OPENING CONDITIONS (SEE APPLICABLE CODE SECTIONS).

2. IT IS RECOMMENDED THAT THE CONTRACTOR REVIEW THE INTENDED CONSTRUCTION WITH THE LOCAL BUILDING CODE OFFICIAL PRIOR TO COMMENCING WORK.

EXISTING	LEGEND	PROPOSED
---	TRaverse LINE, CENTER LINE OR BASELINE (LABEL AS SUCH) 12+00	---
---	RIGHT OF WAY LINE	---
---	PROPERTY LINE	---
---	EDGE OF PAVEMENT	---
---	CURB	---
---	DEPRESSED CURB	---
---	SIDEWALK	---
---	FENCES	---
---	TRAILINE	---
---	ROADWAY SIGNS	---
---	WETLAND LINE	---
---	MUNICIPAL BOUNDARY LINE	---
---	"I" INLET	---
---	"E" INLET	---
---	STORM MANHOLE	---
---	SANITARY MANHOLE	---
---	FLARED END SECTION	---
---	HEADWALL	---
---	HYDRANT	---
---	POLE MOUNTED LIGHT	---
---	CONTOURS	---
---	SPOT ELEVATION	---
---	DIRECTION OF OVERLAND FLOW	---
---	TOP OF CURB ELEVATION	---
---	BOTTOM OF CURB ELEVATION	---
---	TOP OF DEPRESSED CURB ELEVATION	---
---	FLUSH CURB ELEVATION	---
---	INFILTRATION TEST LOCATION	---

SCALE: 1" = 30'

FFE: 89.50
LOADING DOCKS: 85.50
PROPOSED BUILDING (WAREHOUSE):
160,120 S.F.
EMPLOYEE PARKING:
89 SPACES
TRAILER LOADING DOCKS:
3 SPACES
TRAILER PARKING:
29 SPACES

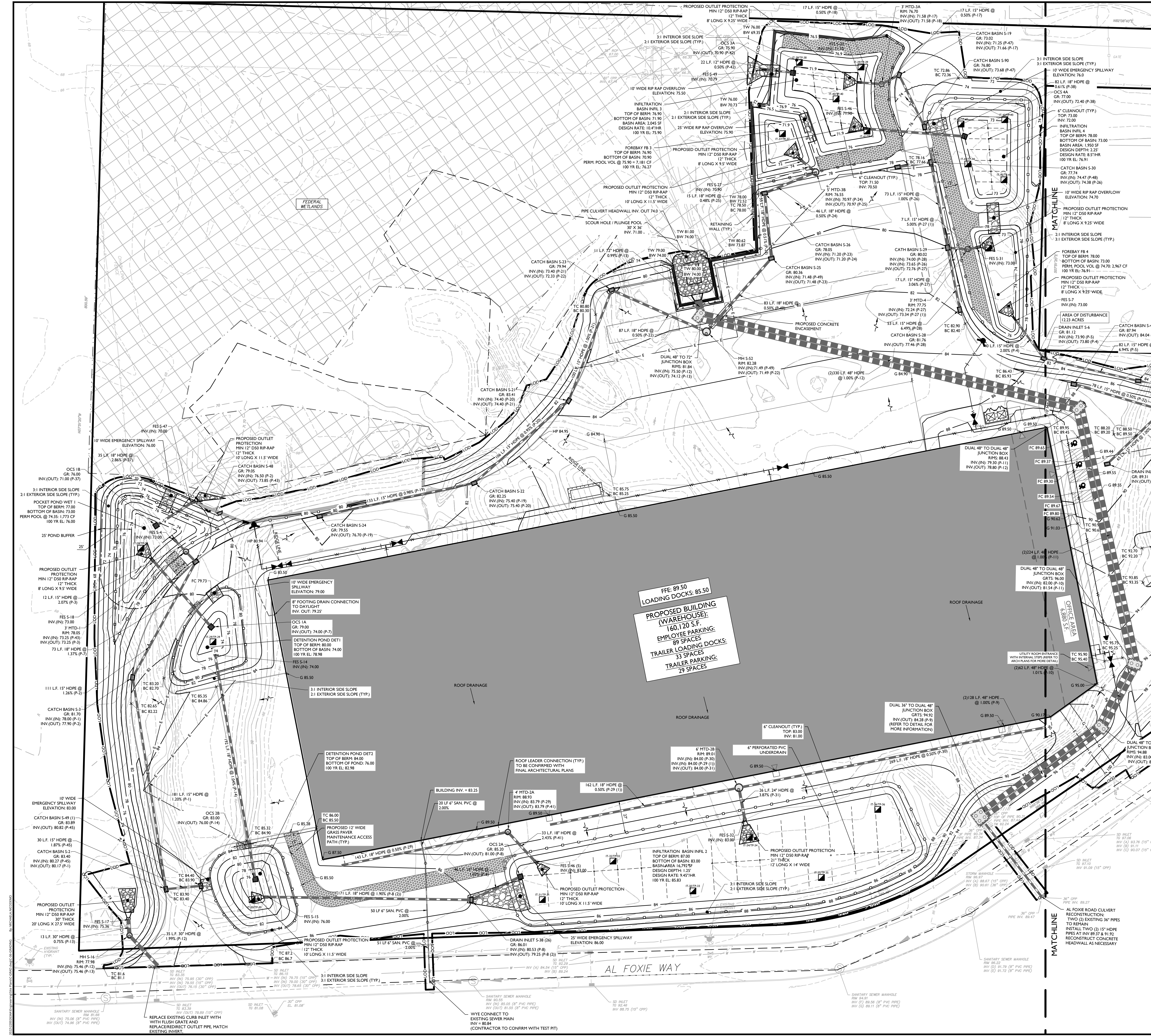

Colliers Engineering & Design

www.colliersengineering.com

Copyright © 2025, Colliers Engineering & Design, Inc. All rights reserved. The drawing and all the information contained herein is a confidential document. It is intended for the use of the client and its authorized representatives only. It is not to be copied, reproduced, distributed, or used for any other purpose without the express written consent of Colliers Engineering & Design.

Doing Business as M.A.S.E.R.

811 PROTECT YOURSELF
ALL STATES REQUIRE NOTIFICATION OF LOCATIONS, DEPTHS, OR ANY OTHER PRECISE INFORMATION TO OBTAIN THE EARTH'S SURFACE AND/OR SUBSURFACE INFORMATION.

FOR STATE SPECIFIC DIRECT PHONE NUMBERS VISIT: WWW.CALL811.COM

REV	DATE	DESCRIPTION	DRAWN BY	CHECKED BY
1	08/03/25	ISSUED FOR REMOVAL OF SUBSURFACE UTILITIES COMMENTS	JAC	JAC
2	08/03/25	ISSUED FOR VARIOUS AGENCY COMMENTS	JAC	JAC
3	07/25/25	ISSUED FOR VARIOUS AGENCY COMMENTS	JAC	JAC
4	07/02/25	ISSUED FOR VARIOUS AGENCY COMMENTS	JAC	JAC
5	07/02/25	ISSUED FOR VARIOUS AGENCY COMMENTS	JAC	JAC
6	07/02/25	ISSUED FOR VARIOUS AGENCY COMMENTS	JAC	JAC

Jesse Barrett Cokley
NEW YORK LICENSED PROFESSIONAL ENGINEER
LICENSE NUMBER: 09087-01
COLLIERS ENGINEERING & DESIGN CT, P.C.
N.Y. C.O.A.# 0017069

PRELIMINARY SITE PLAN
FOR
622 ROUTE 303 LLC
PROJECT AL FOXIE

SBL: 65.14-1-11.2 & 11.3

TOWN OF ORANGETOWN
ROCKLAND COUNTY
NEW YORK STATE

WOODCLIFF LAKE
300 TEE BOLLWEGER
Suite 101
Woodcliff Lake, NJ 07077
Phone: 973.352.0411
COLLIERS ENGINEERING & DESIGN, INC.
DOING BUSINESS AS MASER (C/O NEW YORK STATE)

Colliers Engineering & Design

SCALE: 1" = 30'

DATE: 01/03/2023
AS SHOWN: MAM
PROJECT NUMBER: 22002634A
DRAWING NUMBER: C-GRAD

DATE: 01/03/2023
AS SHOWN: MAM
PROJECT NUMBER: 22002634A
DRAWING NUMBER: C-GRAD

SHEET TITLE: **GRADING & DRAINAGE PLAN - WEST**

SHEET NUMBER: **06 of 23**

NOTE: DO NOT SCALE DRAWINGS FOR CONSTRUCTION.

