

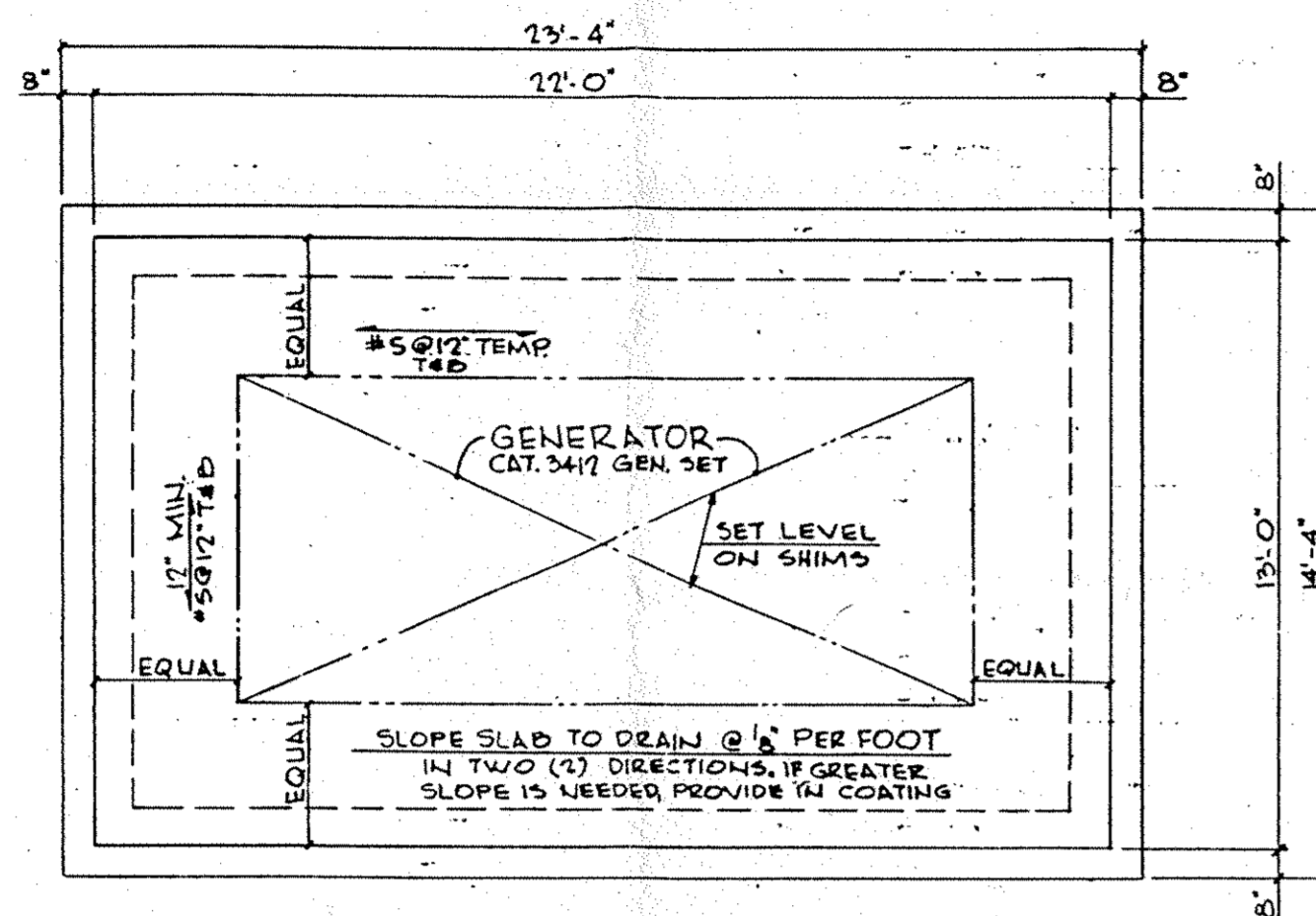

PALISADES PARK, N.Y.



### GENERATOR PAD

SCALE: 1/8" = 1'-0"

1. FOR LOCATION & ORIENTATION SEE ARCH'L & MECH'L DWGS.
2. FOR LOCATION OF DRAIN & CONDUITS, SEE ARCH'L, MECH'L & ELECT'L DWGS.
3. AFTER 28 DAYS OF CURING, THE NEW PAD/MOAT SHALL BE COATED WITH "CORCHEM 204 HIGH BUILD EPOXY" COATING IN ACCORDANCE W/ MANUFACTURER'S SPECIFICATIONS, REQ'TS & RECOMMENDATIONS. THE COLOR SHALL MATCH THE IBM SITE STANDARD.

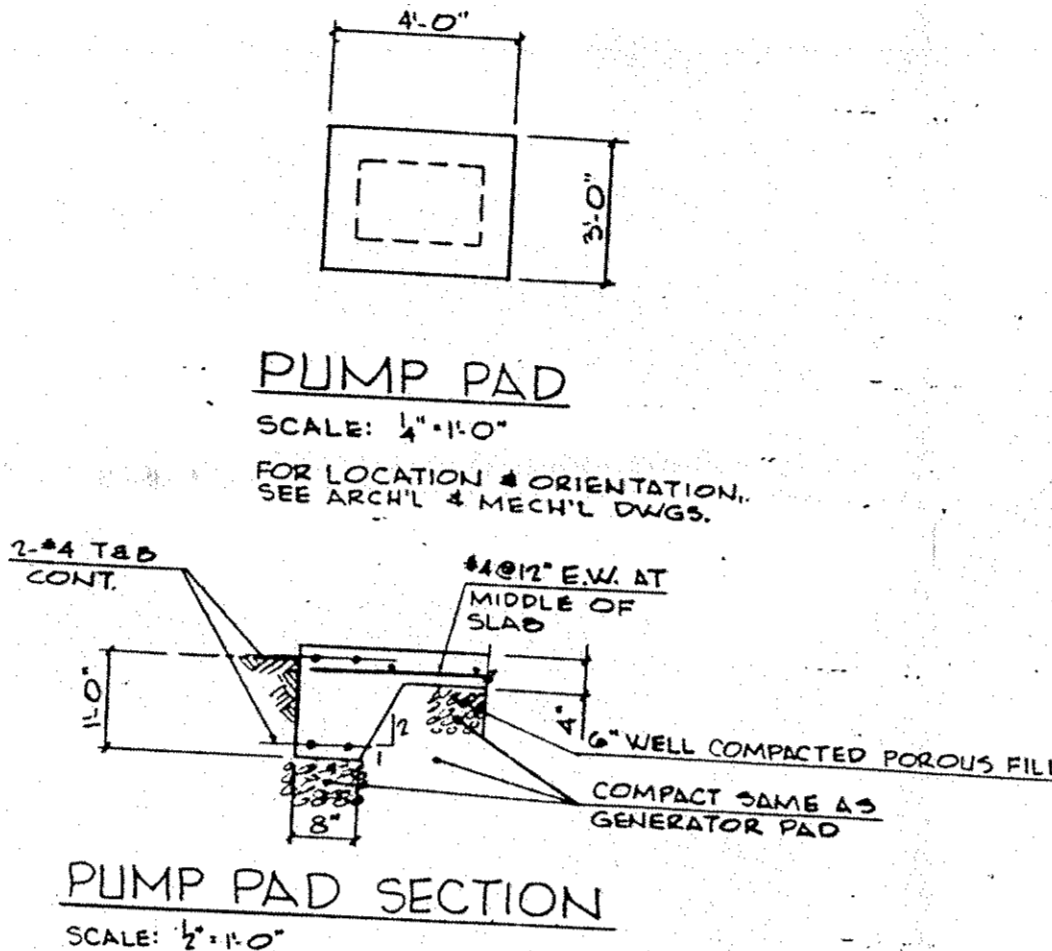

### PUMP PAD

SCALE: 1/8" = 1'-0"

FOR LOCATION & ORIENTATION, SEE ARCH'L & MECH'L DWGS.

4" x 4" x 4" T&D

1" x 4" EW AT MIDDLE OF SLAB

6" WELL COMPACTED POROUS FILL

CONCRETE SAME AS GENERATOR PAD

### PUMP PAD SECTION

SCALE: 1/8" = 1'-0"

#### GENERAL NOTES

1. VERIFY ALL DIMENSIONS AND CONDITIONS IN THE FIELD BEFORE FABRICATING ANY STEEL.
2. ALL CONSTRUCTION AND DEMOLITION WORK SHALL CONFORM TO STATE AND LOCAL BUILDING CODE REQUIREMENTS.
3. DETAILED SHOP DRAWINGS TO BE SUBMITTED TO CONSULTANT FOR APPROVAL PRIOR TO FABRICATION. SUBMIT WITH ALL DIMENSIONS AND FIELD CONDITIONS.
4. CONSULTANT SHALL BE INFORMED OF ANY DISCREPANCIES FOUND IN THE FIELD. CONTRACTOR MUST GET CONSULTANT'S APPROVAL FOR ANY CHANGE IN DRAWINGS.
5. ALL DEBRIS SHALL BE DISPOSED OF PROMPTLY IN A MANNER CONSISTENT WITH ALL LOCAL CODES AND ORDINANCES.
6. PROVIDE ADEQUATE PROTECTION AGAINST FIRE AND MAINTAIN FIRE PROTECTION AT ALL TIMES.
7. ALL EXISTING ADJOINING STRUCTURES, EQUIPMENT, DUCTS, PIPING, ETC. ARE NOT TO BE DISTURBED.

#### FOUNDATION

1. BEARING STRATA SHALL BE COMPACTED TO A MINIMUM OF 95% MODIFIED PROCTOR.
2. CONCRETE PAD SHALL BEAR ON SOIL HAVING A MINIMUM BEARING CAPACITY OF ONE (1) TON PER SQUARE FOOT.
3. BEARING STRATA FOR CONCRETE PAD SHALL REMAIN DRY.

#### CONCRETE NOTES

1. REINFORCED CONCRETE SHALL BE IN ACCORDANCE WITH THE LATEST ACI 318 BUILDING CODE AND ACI DETAILING MANUAL.
2. CONCRETE SHALL BE STONE CONCRETE HAVING A MINIMUM COMPRESSIVE STRENGTH OF 3,500 PSI AT 28 DAYS, AND BE AIR-ENTRAINED WITH BETWEEN FOUR AND SEVEN PERCENT (4-7%) ENTRAINMENT AIR. CONTRACTOR SHALL SUBMIT DESIGN MIX FOR CONCRETE FOR A MINIMUM COMPRESSIVE STRENGTH OF 25% GREATER THAN REQUIRED.
3. REINFORCING STEEL SHALL BE ASTM A615 GRADE 60 AND SHALL BE EPOXY COATED. EPOXY COAT ALL ENDS OF REBARS, AND WHERE EPOXY HAS BEEN REMOVED, SUBMIT EPOXY CATALOG USED FOR REVIEW.
4. SUBMIT CYLINDER TEST REPORT FOR CONCRETE STRENGTH, ONE (1) AT 7 DAYS AND THREE (3) AT 28 DAYS FOR EVERY 50 CUBIC YARDS AND/OR EACH DAY'S POUR. SUBMIT TEST RESULTS TO CONSULTANT.
5. BONDING AGENT SHALL BE HIGH MODULUS AND HIGH STRENGTH BONDING COMPOUND. CONTRACTOR SHALL SUBMIT SPECIFICATIONS OF BONDING COMPOUND FOR APPROVAL.
6. ALL CAST-IN-PLACE CONCRETE SHALL BE CURED AS PER ACI 318-99, SECTION 5.11.
7. LAP ALL BARS A MINIMUM OF 40 BAR DIAMETERS, UNLESS NOTED. STAGGER LOCATION OF SPICES.
8. CONCRETE SHALL HAVE A SLUMP OF 5" PLUS OR MINUS 1" AND BE FULLY VIBRATED.

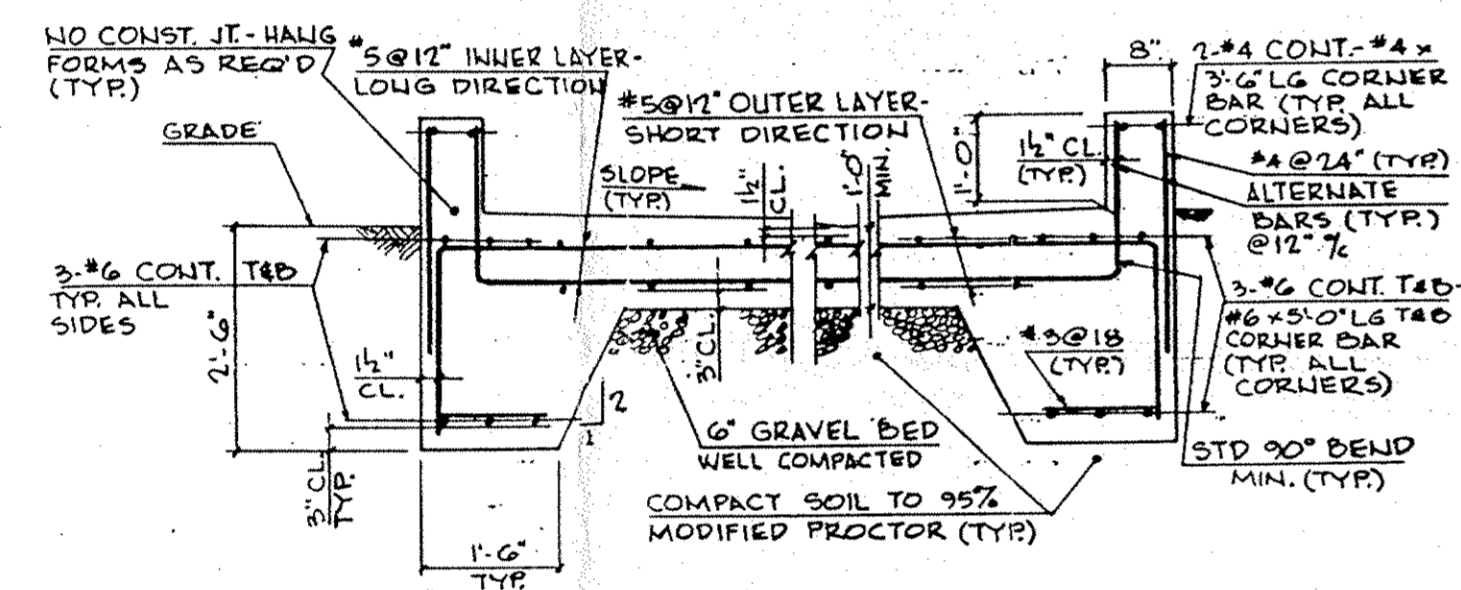

### TYPICAL SECTION

Legend

Notes

Reference Notes

Reference Notes

Reference Notes

Any Plan

No. Date Issue By

No. Date Revisions By

Notes

Notes

Consultant

**VSA GROUP**  
 ARCHITECTS - ENGINEERS - CONSULTANTS  
 441 LEXINGTON AVENUE 18TH FL.  
 NEW YORK, NY 10017  
 (212) 250-0801 Fax (212) 250-0821

THE SWITZER GROUP, INC.

120 FDR Avenue, New York, NY 10017 Tel 212.625.1315 Fax 212.625.8225

The above drawings, plans and specifications are the property of The Switzer Group Inc. Contractor is responsible for checking all dimensions and conditions at job site, as well as building rules and regulations including building elevations. Contractors and all other organizations should be checked with The Switzer Group, Inc. prior to fabrication of job work. Contractor is responsible for correcting same at his own expense. Use of these designs for any other purpose is unauthorized.

Drawing Title

GENERATOR PAD-PLAN & SECTION

Date 11/13/02 Job No.

Scale AS NOTED Drawn By AJG

Prof. Mgr. AJG Checked By HJS

Seal Seal

APPROVED FOR FILING  
 March 29, 2004  
 OFFICIAL DESIGN BOARD  
 Chief Engineer  
 No. 02882

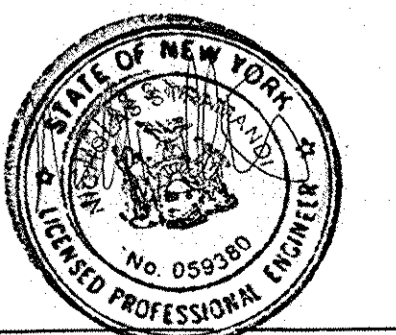

Floor No. Dug No.